

Accumulator

Explanation of Item Number

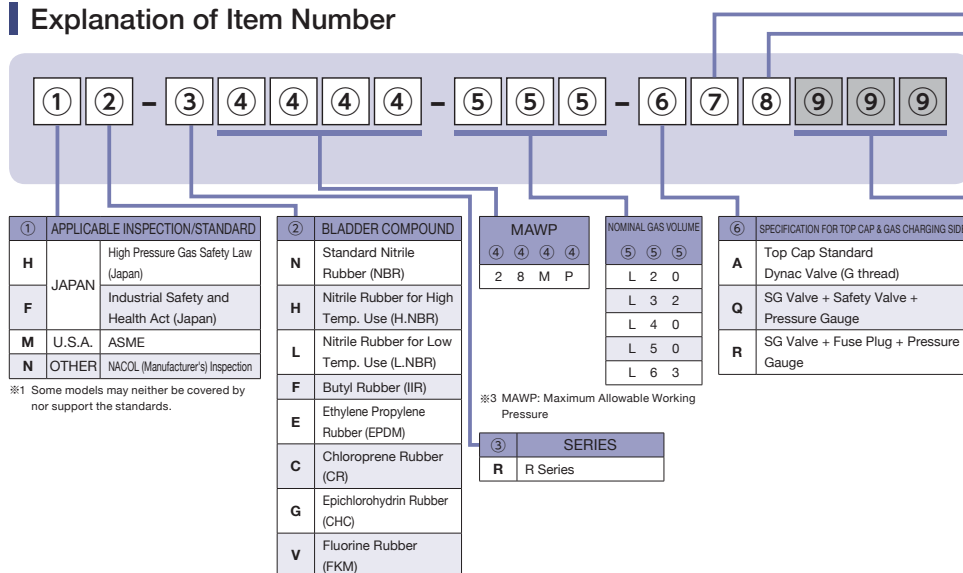

⑦	SPECIFICATION FOR OIL PORT SIDE
A	Carbon Steel
D	Stainless Steel ※4

※4 When selecting D, please contact us.

⑧	SPECIFICATION OF SHELL	SURFACE TREATMENT	SERVICE FLUID
C	Standard Material (Carbon Steel)	Inside & Outside Surface : Zinc Phosphate Treatment (Standard)	Petroleum Based Hydraulic Oil & Other Fluid
D			Water + Glycol Fluid
A		Inside & Outside Surface : Standard Paint Coating	Petroleum Based Hydraulic Oil & Other Fluid ※5
B		Inside Surface : Standard Paint Coating	Petroleum Based Hydraulic Oil & Other Fluid ※5
N		Outside Surface : Zinc Phosphate Treatment	Petroleum Based Hydraulic Oil & Other Fluid
W		Inside Surface : Zinc Phosphate Treatment	Petroleum Based Hydraulic Oil & Other Fluid
H		Outside Surface : Standard Paint Coating	Water + Glycol Fluid
H		Inside & Outside Surface : Standard Plating	Petroleum Based Hydraulic Oil - Water + Glycol Fluid & Other Fluid

※5 Inner surface coating is unsuitable when using fire resistant fluids that may cause the paint to peel off, such as phosphate ester based fluids and water glycol fluids.

⑨ ⑨ ⑨	SPECIAL SPECIFICATION
***	For special specifications, the item number designation includes a three-digit number.

Dimensional Drawing

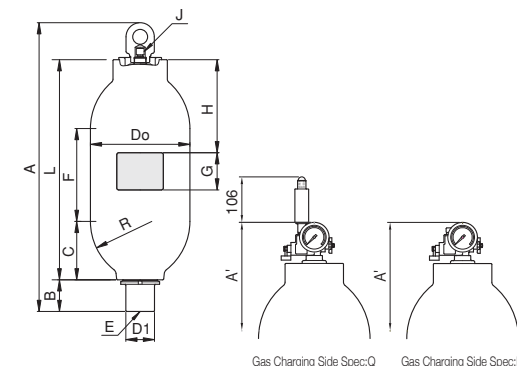

Dimensional Table

Maximum Allowable Working Pressure MPa	Item Number	Nominal Gas Volume L	Mass kg	A ^{+17 0} mm	A ^{+17 0} mm	L mm			B mm	C mm	F mm	H mm	G mm	φDo±1% mm	φD1 mm	R mm	E	J	Allowable Oil Flow Rate [When Vertically Installed 16~320cSt]
28	① ② - R 2 8 M P - L 2 0 - ⑥ ⑦ ⑧	20	105	896	903	719			78	164	375	250	90	267.4	67.2	165	M50x2	G3/8	450L/min
	① ② - R 2 8 M P - L 3 2 - ⑥ ⑦ ⑧ ※6	32	145	1,215	1,222	1,038					694	400							
	① ② - R 2 8 M P - L 4 0 - ⑥ ⑦ ⑧ ※6	40	180	1,427	1,434	1,250					906	700							
	① ② - R 2 8 M P - L 5 0 - ⑥ ⑦ ⑧	50	215	1,693	1,700	1,516					1,172	1,000							
	① ② - R 2 8 M P - L 6 3 - ⑥ ⑦ ⑧	63	265	2,037	2,044	1,860					1,516	1,000							

※6 Dimensions without tolerance indication are for reference. Please confirm the dimensions with the actual product.

※7 R series 32 L and 40 L accumulators use a seamed bladder (not a seamless one-piece bladder).

Typical Exploded View

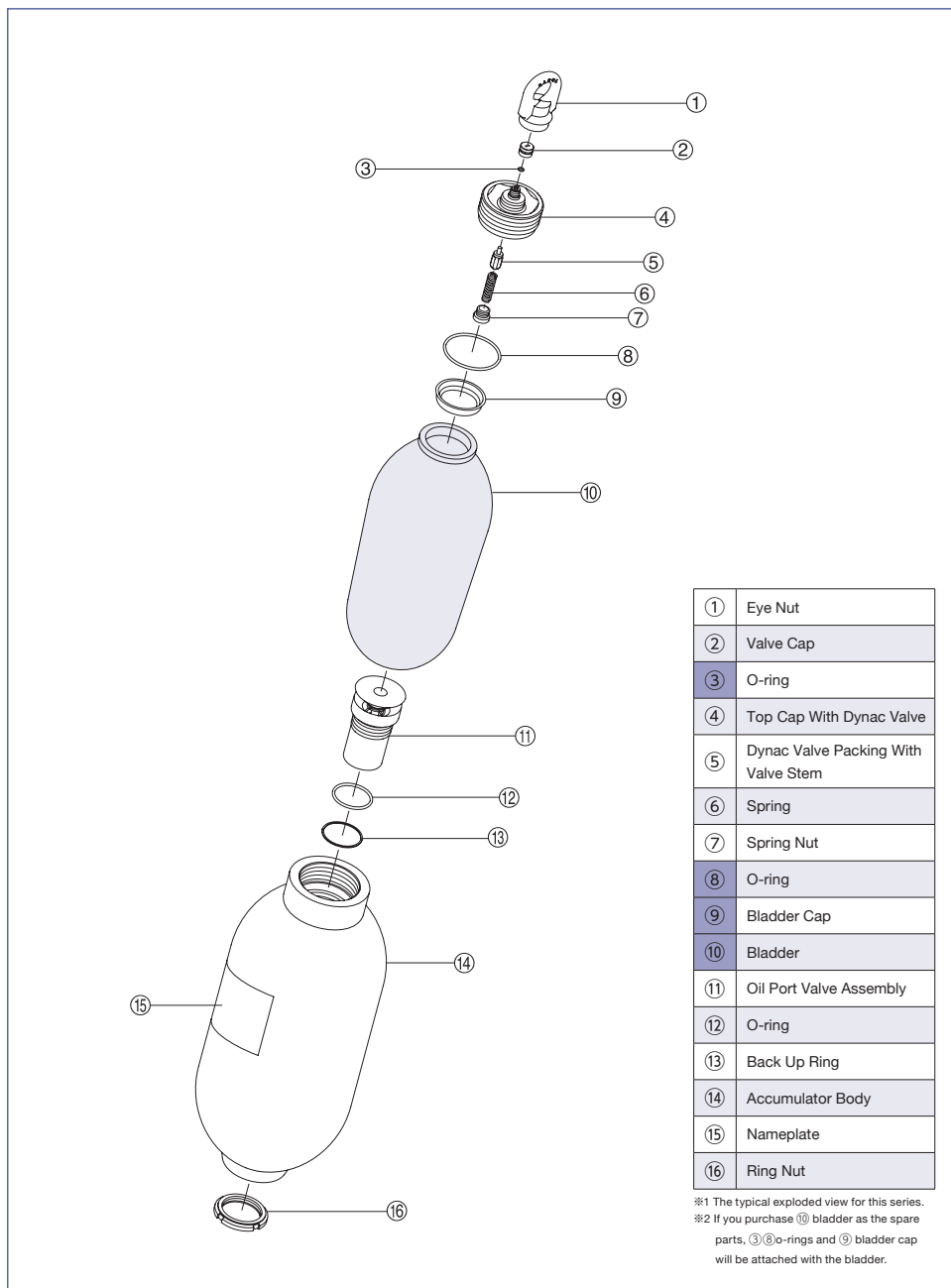

Piping Connection

Dimensional Drawing

● Bushing

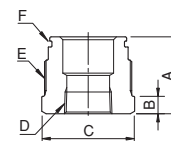

● Flange (with Counter Flange)

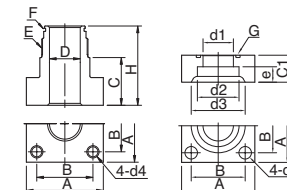

● Valve Flange

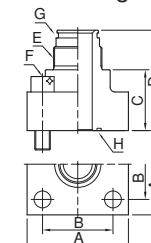

※1 The above shows the shape of representative model. Confirm the actual shape with the drawing or the actual product.

※2 When there is no indication of maximum allowable working pressure of your accumulator in the column of "Applicable ACC. MAWP" of the following dimensional table, please contact us.

Dimensional Table

● Bushing

Applicable ACC. MAWP	Item Number	Connection Port Size	A	B	C	D	E	F	
								O-Ring	B.U. Ring
28MPa	6RCM50R02N28M	Rc1/4	53	12	φ60 (Width across flat 54)	Rc1/4	M50x2	JIS B2401 G40	JIS B2407 G40
	6RCM50R03N28M	Rc3/8				Rc3/8			
	6RCM50R04N28M	Rc1/2				Rc1/2			
	6RCM50R06N28M	Rc3/4				Rc3/4			
	6RCM50R08N28M	Rc1				Rc1			
	6RCM50R10N28M	Rc1-1/4	77	36	φ65 (Width across flat 60)	Rc1-1/4			

● Flange (with Counter Flange)

Applicable ACC. MAWP	Item Number	CPS	A	B	C	H	e	φD	C1	φ d1	φ d2	φ d3	φ d4	φ d5	E	F		
																O-Ring	B.U. Ring	G
28MPa	6FCM5050AN28M	50A	130	90	50	91	20	30	50	43.1	61.1	79	M20	22	M50x2	JIS B2401 G40	JIS B2407 G40	G55

● Valve Flange



















Valve Flange

(mm)

Applicable ACC. MAWP	Item Number	CPS	A	B	C	D	E	F	G		H	
									O-Ring	B.U. Ring		
28MPa	6FCM5025DX007	25A	φ106	52	110	151	M50x2	M16x55	JIS B2401 G40	JIS B2407 G40	G35	
	6FCM5032DX002	32A	106	77	36	77		M16x60			G40	
	6FCM5040DX001	40A	105	73	53	94						

CPS: Connection Port Size MAWP: Maximum Allowable Working Pressure

Accessories/Tools

Maximum Allowable Working Pressure MPa				28	
Item Number of Accumulator				①②-R28MP-L20-⑥⑦⑧	
				①②-R28MP-L32-⑥⑦⑧	
				①②-R28MP-L40-⑥⑦⑧	
				①②-R28MP-L50-⑥⑦⑧	
				①②-R28MP-L63-⑥⑦⑧	
Optional Parts	Gas Charging Tools Kit ※ 1			☞ P204	6GH <input type="text"/> <input type="text"/> <input type="text"/> <input type="text"/> <input type="text"/> <input type="text"/> <input type="text"/>
	For Installation	NACOL Clamp		☞ P200	6KH267
		NORMA Clamp		☞ P201	6081C267
		Base Mounting Plate (Exclusively for NACOL Clamp)		☞ P199	
		Base Mounting Plate (Exclusively for NORMA Clamp)		☞ P199	6BMP267
Bladder Replacement	Parts	Bladder		☞ P210	65②R⑤⑤⑤A
		Bladder Back Up Ring			—
	Tools	Cap Wrench		☞ P208	6TWH81
Dynac Valve Replacement (DV Spec.)	Parts	Dynac Valve Packing with Valve Stem		☞ P212	645026400A
		Spring		☞ P212	645045500
		Spring Nut		☞ P212	645048200
	Tools	Spring Nut Key		☞ P212	6TWH04
For Oil Port Valve Assembly	Tools	Ring Nut Wrench		☞ P209	6TWD085
Separately Available Parts	Eye Nut (Hanging Tool)				6HTM42
	Valve Cover				645049705
	Exclusively for Q/R Spec.	SG Valve		☞ P196	6H <input type="text"/> -AV35MP-F03-M42A
		Pressure Gauge Containing Glycerol		☞ P197	6018DUF0206 <input type="text"/> <input type="text"/> <input type="text"/> <input type="text"/> G
		Spring Loaded Type Safety Valve		☞ P198	6H-SV <input type="text"/> <input type="text"/> <input type="text"/> <input type="text"/> -03-F03
		Fuse Plug		☞ P197	6H-FP35MP-03-F03

※1 Nitrogen gas charging, inspection, or pressure adjustment requires a gas charging tools kit.
(Only a hose and an adaptor are required for R or Q specification accumulator with SG valve.)