

Features

- ❶ **Heavy-Duty Roller Bearing** supports high side loads and receives forced lubrication for cooling and increased life.
- ❷ **Roller Stator® Motor** available in displacements up to 127.7 cubic inches for tremendous torque output.
- ❸ **Three-Zone Orbiting Valve** precisely meters oil to produce exceptional volumetric efficiencies.
- ❹ **Heavy-Duty Drive Link** receives forced lubrication for long life and is capable of extreme duty cycles.
- ❺ **Compact Housing** contributes to high power-to-weight ratio of motor and offers front and rear mounting flanges.

DT Series

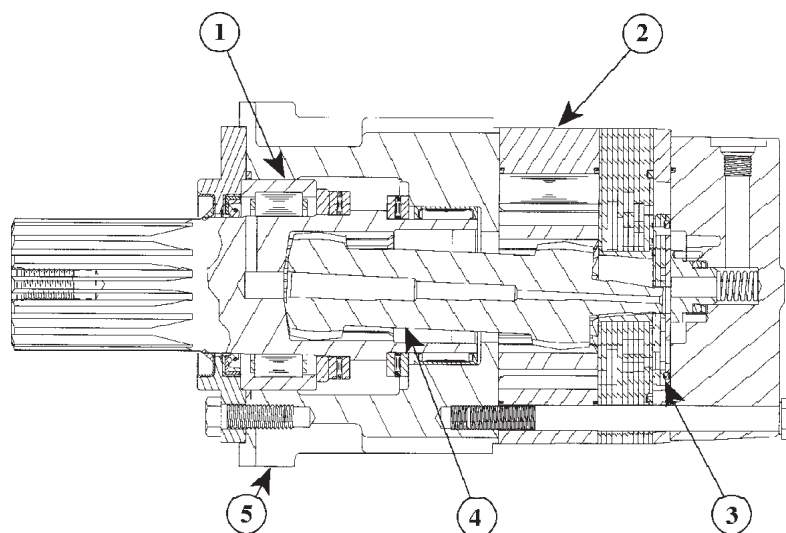

Tremendous Torque, Compact Design

The most amazing aspect of the DT Series motors is its huge torque potential from its relatively small size. The DT Series motor is capable of producing output torque comparable to competitive designs, but from a package that is both shorter and much lighter. This savings in space and weight in no way compromises durability, as the motor uses massive shafts, bearings, and drive links to transmit the torque developed by this powerful package. The use of a case drain allows reduced pressure on the shaft seal while maintaining driveline lubrication for maximum motor life. Standard mounting and shaft options offer interchangeability with competitive designs. An internal drain option is also available.



Specifications

Code	Displacement in ³ /rev (cm ³ /rev)	Max Speed RPM		Max Flow GPM (LPM)		Max Torque lb-in (Nm)			Pressure DPsi(DBar)		
		Cont.	Inter.	Cont.	Inter.	Cont.	Inter.	*Stall	Cont.	Inter.	Peak
19	18.3 (300)	320	380	25 (95)	30 (114)	7250 (812)	8450 (946)	6275 (709)	3000 (207)	3500 (241)	3750 (259)
25	22.8 (375)	250	300	25 (95)	30 (114)	9250 (1036)	9975 (1117)	8260 (933)	3000 (207)	3250 (224)	3500 (241)
28	28.3 (465)	200	240	25 (95)	30 (114)	9475 (1061)	12300 (1378)	8595 (971)	2500 (172)	3250 (224)	3500 (241)
33	32.7 (536)	180	210	25 (95)	30 (114)	11300 (1266)	13500 (1512)	10240 (1157)	2500 (172)	3000 (207)	3500 (241)
46	45.6 (748)	130	150	25 (95)	30 (114)	15750 (1764)	18500 (2072)	14780 (1670)	2500 (172)	3000 (207)	3500 (241)
56	56.7 (929)	100	120	25 (95)	30 (114)	15750 (1764)	18950 (2122)	14050 (1588)	2000 (138)	2500 (172)	3000 (207)
66	63.9 (1048)	90	110	25 (95)	30 (114)	16950 (1898)	20500 (2296)	16215 (1832)	2000 (138)	2500 (172)	3000 (207)
91	91.2 (1496)	60	70	25 (95)	30 (114)	18500 (2072)	20500 (2296)	18120 (2048)	1500 (103)	1750 (197)	2000 (138)
99	127.7 (2094)	40	50	25 (95)	30 (114)	23550 (2649)	29580 (3328)	23800 (2689)	1500 (103)	1750 (197)	2000 (138)

* Stall torque measured at 1 RPM at continuous pressure per SAE J746b.

Dimensions

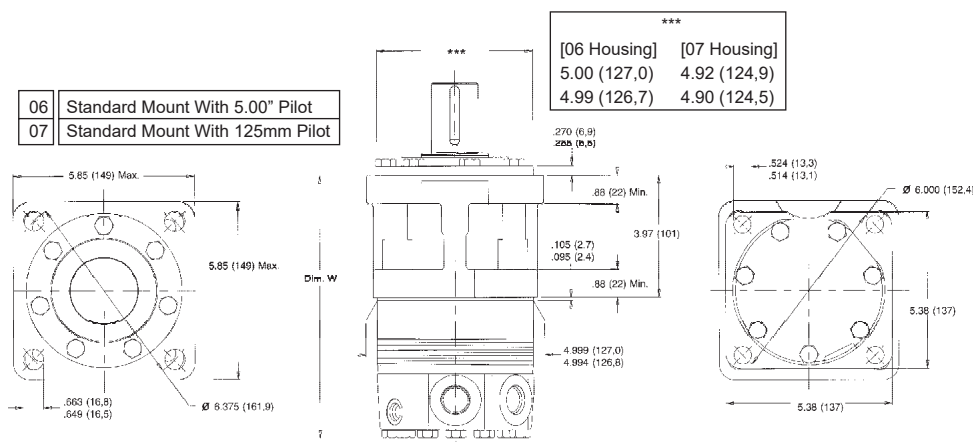

Length and Weight Tables

Standard Mount

Disp. Code	Dim. W in (mm)	Weight lbs (kg)
19	8.25 (209)	44.6 (20.2)
25	8.50 (216)	45.8 (20.8)
27	8.80 (223)	47.1 (21.4)
33	9.04 (230)	48.2 (21.9)
46	9.75 (248)	51.3 (23.3)
56	10.35 (263)	53.8 (24.4)
66	10.75 (273)	55.7 (25.3)
91	12.25 (311)	62.5 (28.3)
99	14.25 (362)	71.3 (32.3)

DT motor weights vary \pm 3 lb. (1.35 kg) depending upon motor configuration.

Subtract .11 in. (3mm) from dimension for motors using 0 or 5 endcover.

Ordering Information



Code	Displacement
19	18.3 in ³ /r (300 cm ³ /r)
25	22.8 in ³ /r (375 cm ³ /r)
28	28.3 in ³ /r (465 cm ³ /r)
33	32.7 in ³ /r (536 cm ³ /r)
46	45.6 in ³ /r (748 cm ³ /r)
56	56.7 in ³ /r (929 cm ³ /r)
66	63.9 in ³ /r (1048 cm ³ /r)
91	91.2 in ³ /r (1496 cm ³ /r)
99	127.7 in ³ /r (2094 cm ³ /r)

Code	Housings
06	Standard Mount with 5" Pilot
07	standard Mount with 125mm Pilot

Code	Shafts
20	1-1/2" Tapered (S)
21	50mm Straight (S)
23	60mm Tapered
24	40mm Straight (S)
25	2-1/4" Straight (S)
26	16 Tooth Spline
28	17 Tooth Spline (S)
32	1-1/2" Straight
36	14 Tooth Spline

(S) Denotes shafts available for use with speed sensor options

Code	Ports
0	Rear Ports 7/8-14 O-ring
5	Radial Ports 1-1/16-12 O-ring
7	Radial Ports 3/4-14 BSP.F
8	Parallel Ports 1-1/16-12 O-ring
9	Parallel Ports 3/4-14 BSP.F

Code	Options
O	No Options
*F	Free Turn (Industrial Use)
D	Internal Drain (Low Pressure)
**R	Valve Cavity
**R1	1000 PSI (69 Bar) Relief Valve Installed
**R2	2000 PSI (138 Bar) Relief Valve Installed
**R3	3000 PSI (207 Bar) Relief Valve Installed
Z	Speed Sensor
Z1	Speed Sensor With Weatherpack Connector

*Standard with 56, 91, and 99 Displacement Codes.

**Available with 0,5, and 7 ports only.